

Commercial Aluminum Fixed Unit
FW-C50**Standard Features**

- 2-5/8" Frame Depth
- T-6063 Aluminum Extrusions with .062" walls
- Thermally Broken Frame
- Factory Glazed with 7/8" Insulated Glass with Super Spacer[®] warm edge spacer technology for superior thermal performance
- Equal Leg Frame
- Interior Glazed – Field Servicable
- Architectural paint finish meets AAMA 2603. Colors available for normal lead times: White, Bronze, and Clear Anodized. For large projects, custom colors are available on a special order basis – please contact our office for details.

Optional Features

- Numerous high performance glazing options
- Mullion for multiple units
- Many Grid Between Glass (GBG) configurations are available for greater design flexibility and low maintenance.
- Three-Piece Mullion and Two-Piece Receptor System
- Optional Nailing Fin and Face Flange

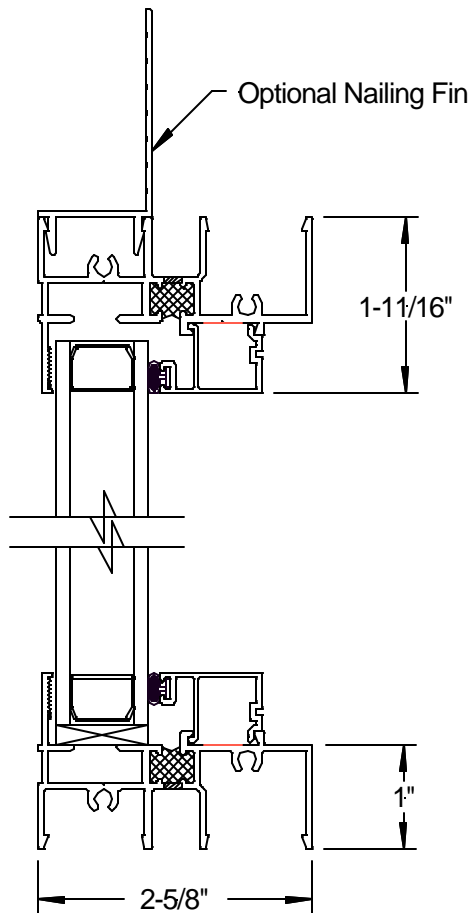

The Westco Projection Series Fixed Unit (used with Casement, Hopper, and Awning windows) is a heavy-duty aluminum light commercial window with a distinctly residential look and feel. Drawing on our many years of residential and light commercial window experience, we have developed a completely new product that blends the pleasing aesthetic appeal of residential windows with the rugged serviceability and performance of thermally broken commercial aluminum. The Westco Projection Series of products rounds out our very popular Westco Single Hung, Slider, and Fixed window lines which have been used in numerous schools, hotels, and other commercial and residential applications for many years.